



Adapter

AD.M50.NPT1-1/2.SS.C.18.K01

- Adapter male thread metric to female thread NPT
- Stainless Steel
- Thread M50
- Thread NPT 1-1/2"
- Seal chloroprene
- Ex db, Ex eb and Ex tb certified
- Suitable for operation in Zone 1, Zone 2, Zone 21 and Zone 22
- Packaging unit: 1 piece, kit with accessories



Dimensions

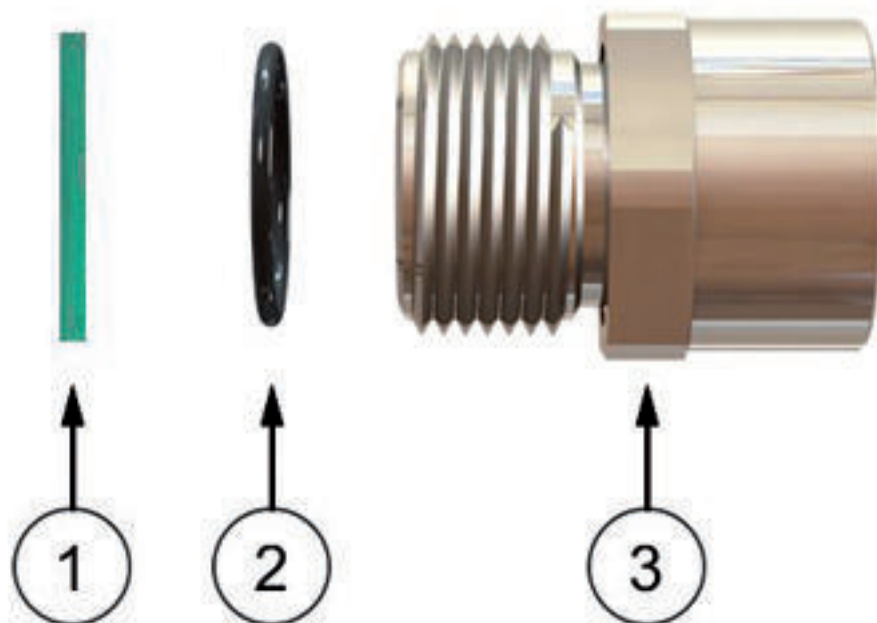

Dimensions

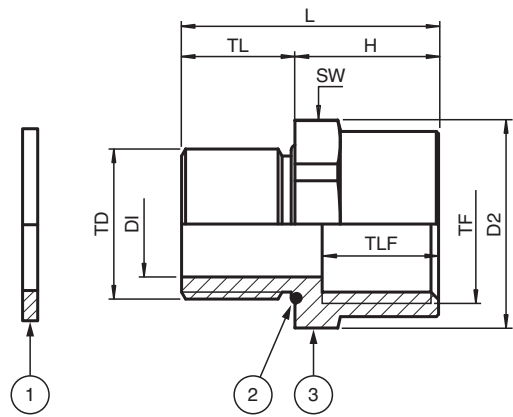

Details see data table

Legend	
1	Washer gasket (accessory, metric threads only)
2	O-Ring (metric threads only)
3	Adapter
DI	Diameter internal hole
D2	Width across corners
H	Length outside enclosure
L	Total length
SW*	Width across flats
TD	Thread size
TF	Thread size female
TL	Thread length
TLF	Thread length female

Technical Data

Mechanical specifications		
Thread type		metric ISO pitch 1.5 mm
Thread size (TD)		M50
Thread type female		NPT ANSI ASME B1.20.1
Thread size female (TF)		NPT 1-1/2"
Degree of protection		IP66 / IP68
Material		
Finish		inherent color silver
Washer gasket		aramid fibers bonded with NBR
Adapter		stainless steel
O-Ring		chloroprene
Mass		
Individual component		approx. 217 g
Packing unit		approx. 282 g
Dimensions		
Width across corners (D2)		61 mm
Diameter internal hole (DI)		40 mm
Length outside enclosure (H)		22 mm
Width across flats (SW1)		55 mm

Refer to "General Notes Relating to Pepperl+Fuchs Product Information".

Technical Data

Thread length (TL)	18 mm
Thread length female (TLF)	18 mm
Total length (L)	40 mm
Tightening torque	
Nut torque at enclosure (SW1)	10 Nm
Ambient conditions	
Ambient temperature	-40 ... 100 °C (-40 ... 212 °F) washer gasket -40 ... 80 °C (-40 ... 176 °F)
Data for application in connection with hazardous areas	
EU-type examination certificate	CESI 15 ATEX 029X
Marking	Ⓔ II 2 GD Ex db IIC Gb Ex eb IIC Gb Ex tb IIIC Db
International approvals	
IECEX approval	IECEX CES 15.0006X
UKCA approval	CML 22 UKEX 1267X
CCoE approval	PESO A/P/HQ/KA/104/5579 (P420366)
CCC approval	2021312313000345
Conformity	
Degree of protection	EN 60529
General information	
Delivery quantity	1
Scope of delivery	Adapter locknut washer gasket Brief instructions
Supplementary information	EC-Type Examination Certificate, Statement of Conformity, Declaration of Conformity, Attestation of Conformity and instructions have to be observed where applicable. For information see www.pepperl-fuchs.com .